

1.08 Double Blind Motorised Roller System Vertilux patent no 2004906134

Technical Information

1. Double brackets Male and female colour coordinated pressed powdercoated steel.
2. Bearing lock UV stabilised nylon with bearing for intermediate and idle end.
3. 40mm / 50mm motor Somfy to suit application.
4. Key tube Aluminium alloy tube, with multiple cloth fixing. 47mm / 56mm external.
5. Motor plate adaptor UV treated nylon.
6. Female tube connector UV stabilised nylon with high resistance to ultraviolet light. Idle end connector. 40mm.
7. Idle end pin lock UV stabilised nylon with high resistance to ultraviolet light. With 4mm tolerance.
8. Base rail Extruded aluminium manufactured to ISO9001 patent Vertilux design available in various colours.

Dimensions & Limitations

MINIMUM WIDTH*	LS 40 - 600mm	MAXIMUM WIDTH*	3100mm
	LT 50 - 700mm	MINIMUM DROP*	500mm
	RTS 40 - 630mm	MAXIMUM DROP*	5000mm
	RTS 50 - 730mm		

Note: Sizes with Fabric widths typically over 3000mm will void warranty.

Standard Base Rail Options

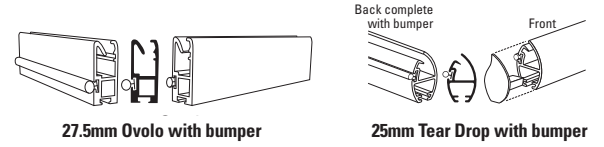

Assembly with Motors at Same End

- 40mm motor with 47mm tube. Max drop 3100mm
- 50mm motor with 56mm tube. Max drop 3200mm

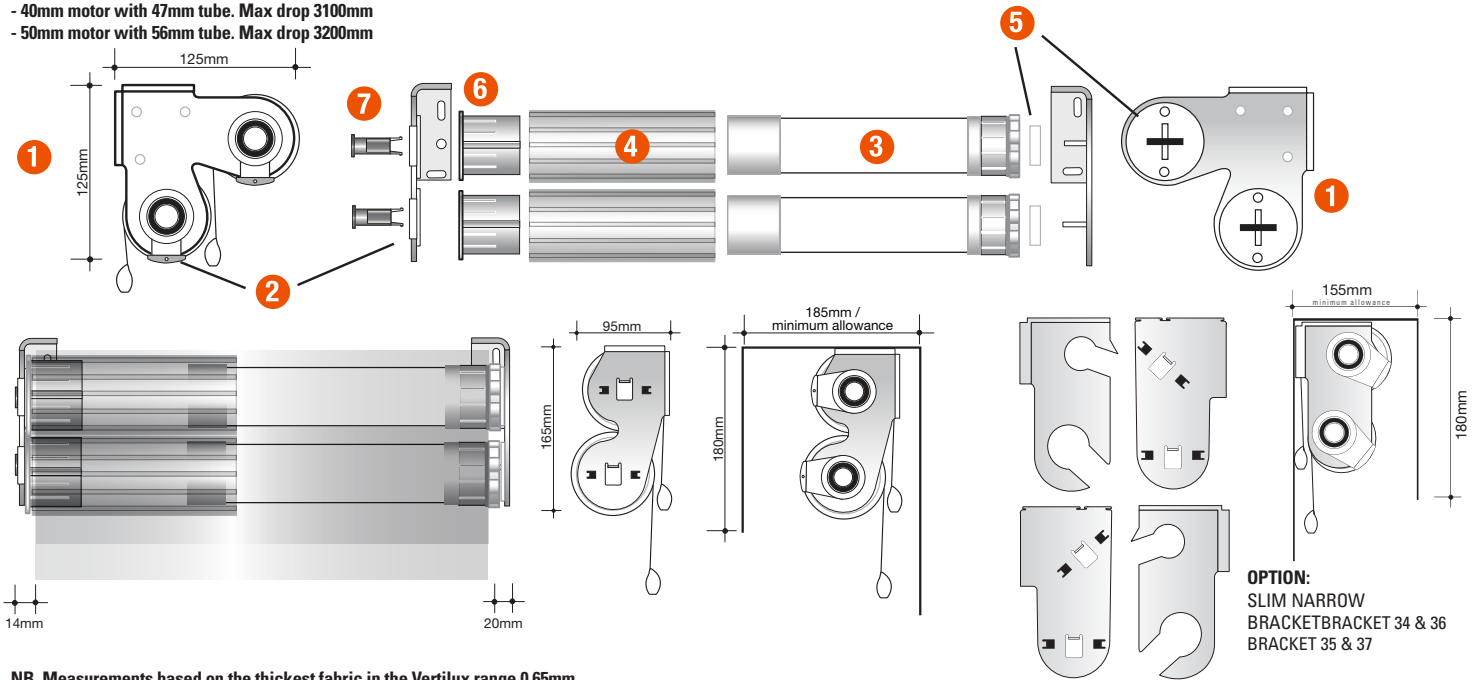

NB. Measurements based on the thickest fabric in the Vertilux range 0.65mm.

Idle End and Motor Brackets

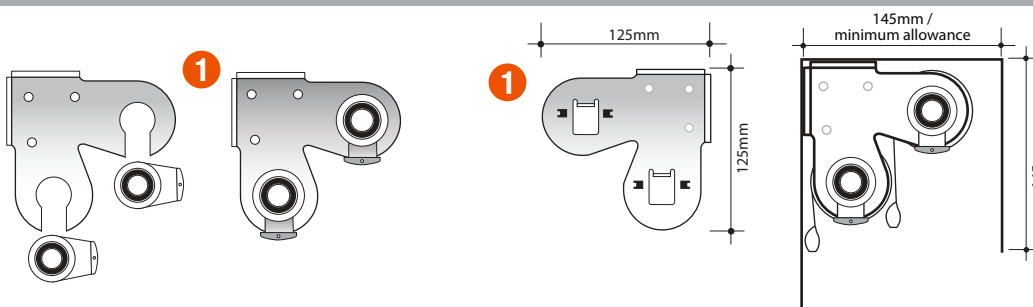

References

