

1.03 Easydrive BGS® Roller Blind System

spring assist booster with counter balance Vertilux patent no 53651-00

Technical Information

1. Clutch Winder with direct action dual reverse clutchwound springs. U.V. stabilised nylon with high resistance to ultraviolet light.
2. Booster High tensity wound steel wire coiled spring booster, with high ratio winding. Vertilux patent no 53651-00.
3. Idle end plug Quick turn spring release for easy pin insertion into bracket. U.V. stabilised nylon.
4. Tube 40mm standard tube - widths from 600mm to 2199mm.
47mm tube - widths from 2200mm - 3299mm.
52mm tube - widths from 3300mm - 3400mm.
5. Brackets Male and female colour coordinated pressed powdercoated steel.
6. Base Rail Extruded aluminium manufactured to ISO9001 patent Vertilux design available in various colours.
7. Chain No.10 chain in either nylon bead chain or stainless steel ball chain.

PLEASE NOTE: Only the clutch in this BGS® roller blind system comes with a 15 year warranty.

Dimensions & Limitations

SIZE	3000mm W x 4500mm D with fabrics/screens of 330-550gms/sqm.
WEIGHT	12.5 Kgs.
MINIMUM WIDTH*	600mm
MAXIMUM WIDTH*	3000mm
MINIMUM DROP*	500mm
MAXIMUM DROP*	4500mm

*** Recommended Tolerances**
Note: Sizes with Fabric widths typically over 3000mm will void warranty.

Standard Base Rail Options

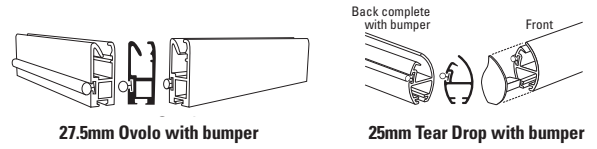

NOTE: Dimensions relate to height of Base Rail.

Componentry

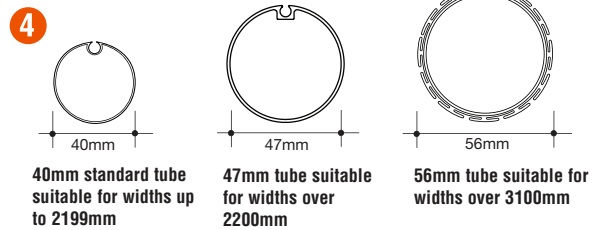
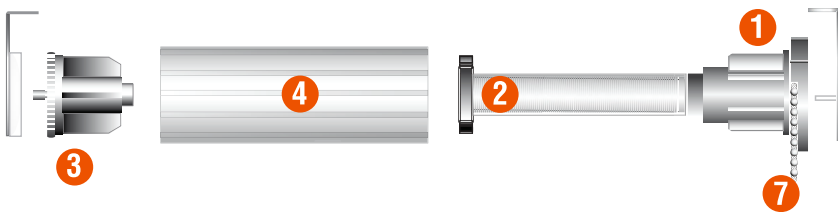

Assembly

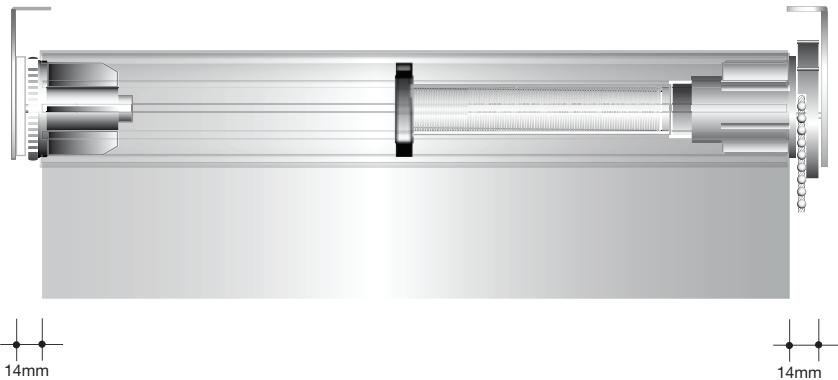

Brackets + Pelmet Allowances

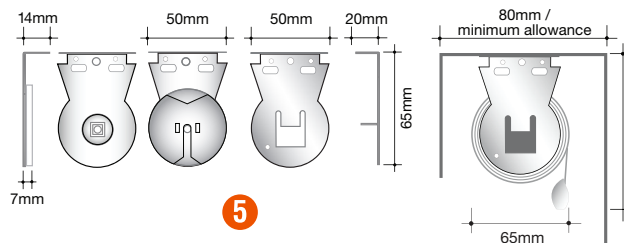

NB. Fabric measurements taken from the thickest fabric available (0.65mm) Calculated over 3000 drop

